

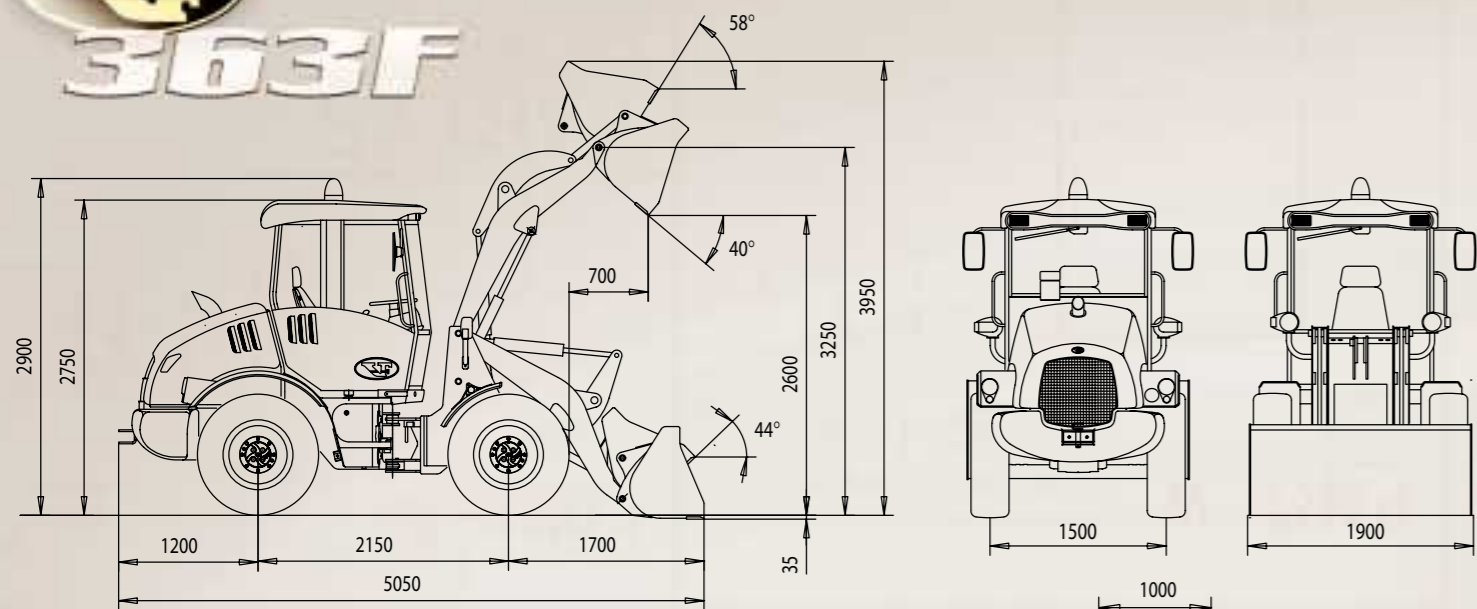

363F



Loading bucket (kg)

Stating tipping load, full turn	2.900
Payload (50%)	1.450

Loading fork (kg) - centre of gravity 500 mm

Stating tipping load, full turn	2.500
Payload EN 474-3 (80%)	2.000
Payload EN 474-3 (60%)	1.500
Payload DIN 24094 (50%)	1.250

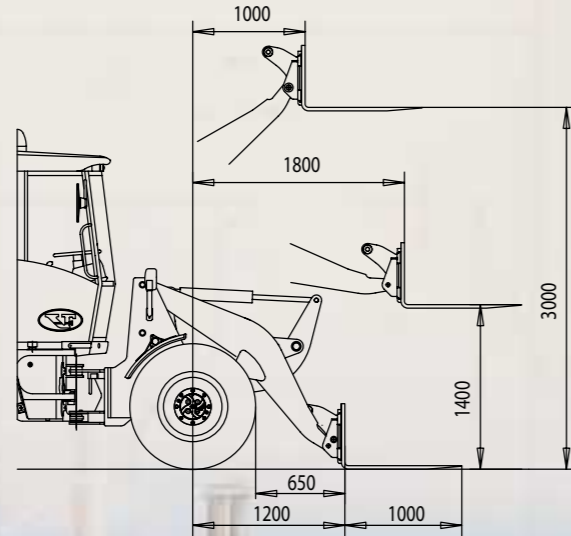

UP-3828 (2004)



363F



www.vf-venieri.com



VF Venieri S.p.A.

AZIENDA CON SISTEMA QUALITÀ
CERTIFICATO DA DNV
= UNI EN ISO 9001/2000 =

VENIERI S.p.A.

Eng



- > Max power 67 cv
- > Bucket capacity 0,8÷1,1 m³
- > Max Operative weight 5150 Kg
- > Hydrostatic transmission
- > 4 wheel drive



Standard equipment

- Acoustic warnings
- 0,8 m³ bucket with bolted teeth
- ROPS/FOPS cab with heater, pressurizer recirculating fan, with front and rear windscreen wiper and windshield washer
- Complete instrument board
- Draw bar hook
- Limited slip differential on the front axle
- Fully adjustable seat
- Operation and maintenance manual
- Plugs with keys for fuel and hydraulic tanks
- Safety clamp for lifting cylinders
- Seat belt
- Side rearview mirrors
- Servocontrols
- Soundproofing
- Spare parts catalogue
- Tool box
- Visual index for bucket position
- Working lights
- Yellow rotating and overturning beacon

Yesterday,
today
and
tomorrow.

> ENGINE

Engine: 4 cylinder, indirect injection diesel engine, water cooled, paper dry filter.

Emissioned according to CEE 97/68.

Type	Perkins 804C-33
Max power	49 kW - 67 CV
Rated rpm	2300
Net power ISO/TR 14396	45 kW - 61 CV
Net power EEC/ 80/1269	45 kW - 61 CV
Bore mm	94
Stroke mm	120
Displacement cm ³	3331

> ELECTRIC SYSTEM

Battery	12 Volt
Capacity EN60095-1	100 Ah - 760 A
Alternator rating	90 A
Reverse warning	Standard
Wiring according with	IP 67 - DIN 40050

> TRANSMISSION

Hydrostatic transmission with automatic power regulation and closed circuit with variable displacement pump and motor. Two forward/reverse speeds with single lever control.

		forward	reverse
1 st gear	km/h	0÷7	0÷7
2 nd gear	km/h	0÷25	0÷25

Automatic second gear on request.

> AXLES

Two heavy duty equal size axles with planetary final drives in each wheel.

Fixed rigid drive axle on front chassis section.

Oscillation drive axle on rear chassis section up to a total angle of 25°.

Transfer gearbox transferring movement directly to the rear and to the front axle via a transmission shaft.

Self locking limited slip differential on front axle.

Self locking limited slip differential on rear axle (optional)

> BRAKES

Service: hydraulic multi-disc oil brake on front axle working on all the wheels.

Parking: mechanical brake operating on the service brake, manually actuated.

> TYRES

Standard	12.5 - 20
Option	405/70 R 18

> STEERING

Servo-assisted steering LOAD SENSING system.

Total steering angle	80°
Inner tyres turning radius	mm 2300
Outer tyres turning radius	mm 4100
Outer bucket turning radius	mm 4500

> HYDRAULIC SYSTEM

Hydraulic gear pump with LOAD SENSING priority valve for the steering circuit.

Modular two-element control valve with main relief valve.

Double acting hydraulic cylinders.

Hydraulic oil cooling radiator.

Full-flow oil filter on the leakage pipe.

Single servo-lever arm control with 4 position lifting system and with 3 position bucket system.

Max flow	lt/1'	64
Loader relief valve pressure	bar	230
Steering relief valve pressure	bar	190
Lift cylinders	mm	70 x 586
Bucket cylinder	mm	80 x 405
Cycle time	sec	9.5

> SERVICES CAPACITIES

Engine	kg	7
Gearbox	kg	2
Differential	kg	3,5
Planetary final drive	kg	2
Hydraulic circuit	kg	45
Brake system	kg	1
Fuel	lt	64
Water cooling	lt	15

> TECHNICAL FEATURES

Standard bucket capacity	m ³	0,8
Bucket width	mm	1900
Static tipping load:		
Straight	kg	3300
Full turn 40°	kg	2900
Lifting capacity at max height	kg	2200
Dump clearance	mm	3250
Dump height at 40°	mm	2600
Reach at 40°	mm	700
Breakout force	kg	5850

> DIMENSIONS AND WEIGHTS

Max length in transfer position	mm	5400
Max width in transfer position	mm	1900
Track	mm	1500
Tracks width	mm	1830
Ground clearance	mm	350
Standard operating weight	kg	4850
Max operating weight	kg	5150

